

Installation instructions for the fabric blind mounted to the wall

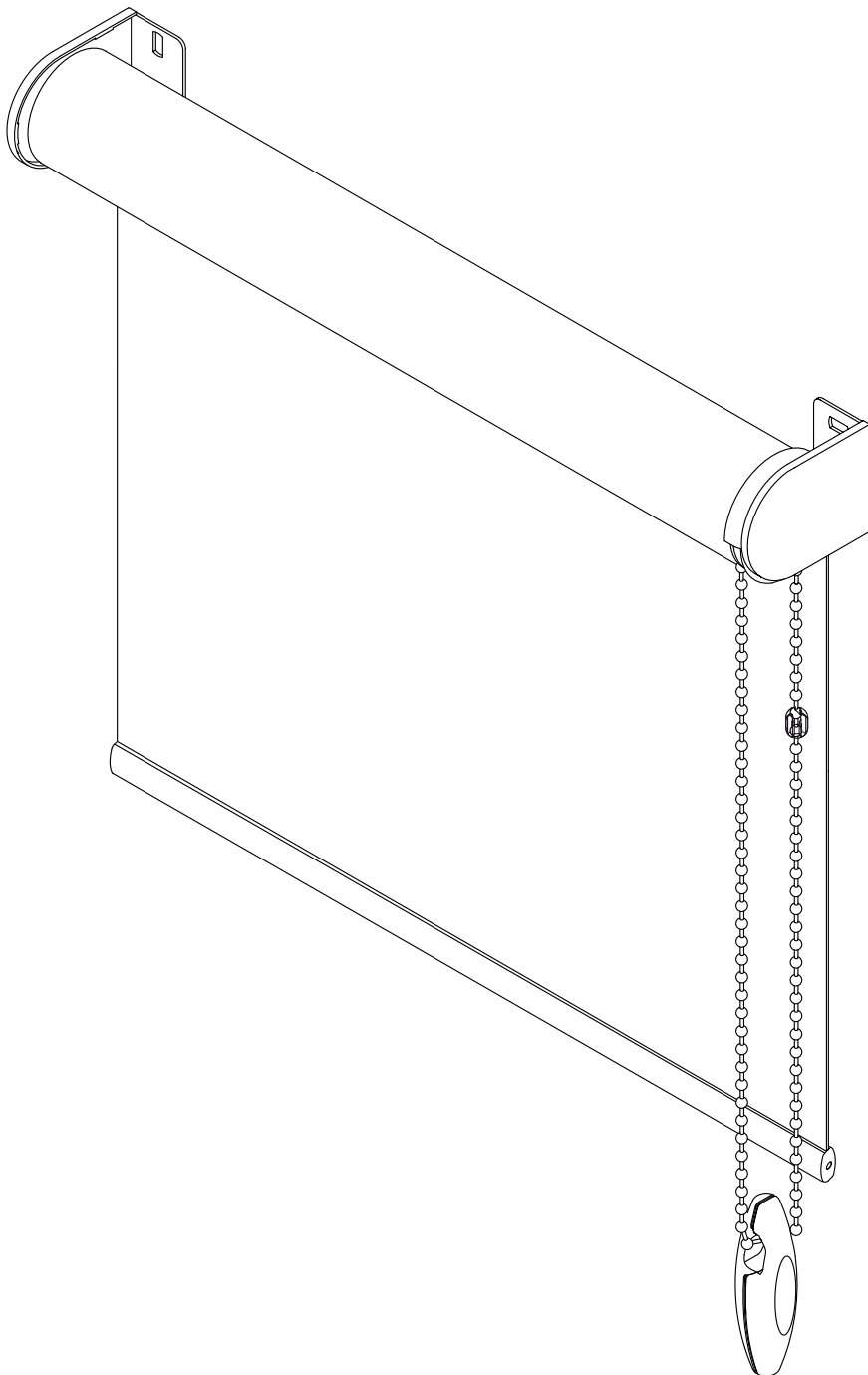

The following mounting elements are included in the set along with the fabric roller blind:

We do not provide the mounting pins. The type of pins depends on the material the walls are built of.

The customer decides which pins to use.

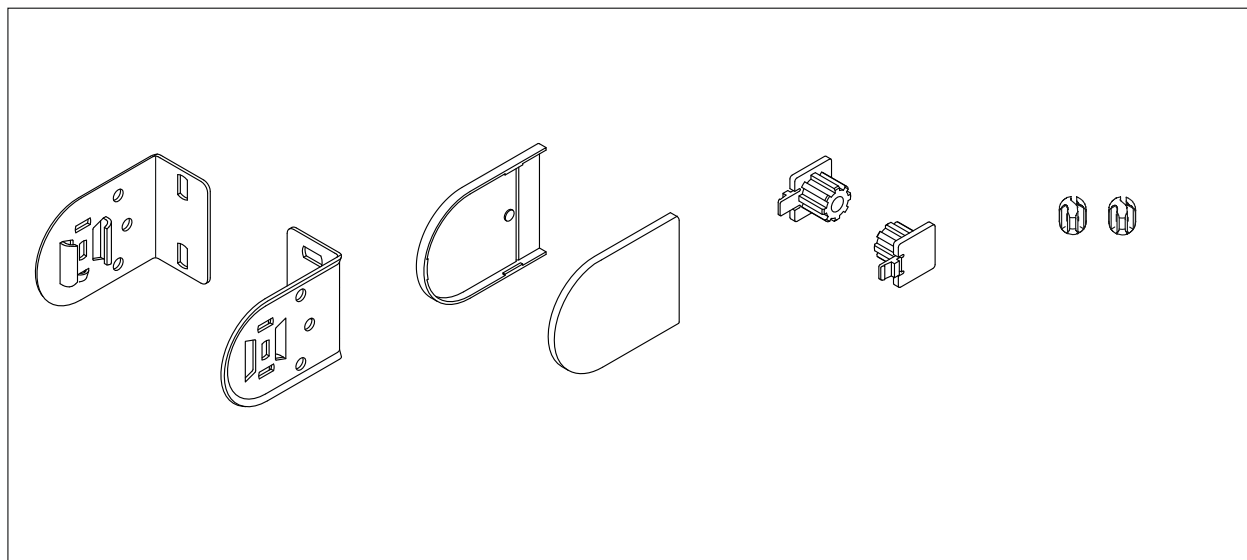

Stage I

Install the mounting hangers. The roller blind will work properly when mounted perfectly horizontal.

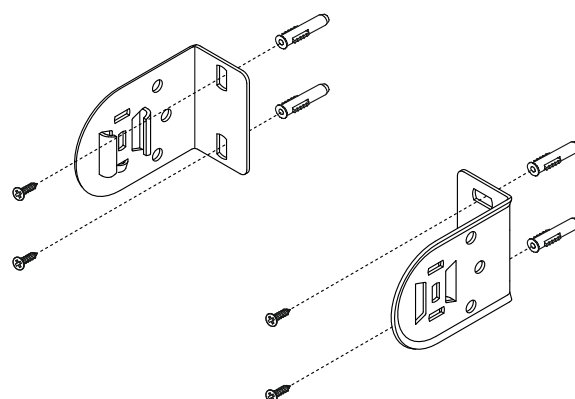
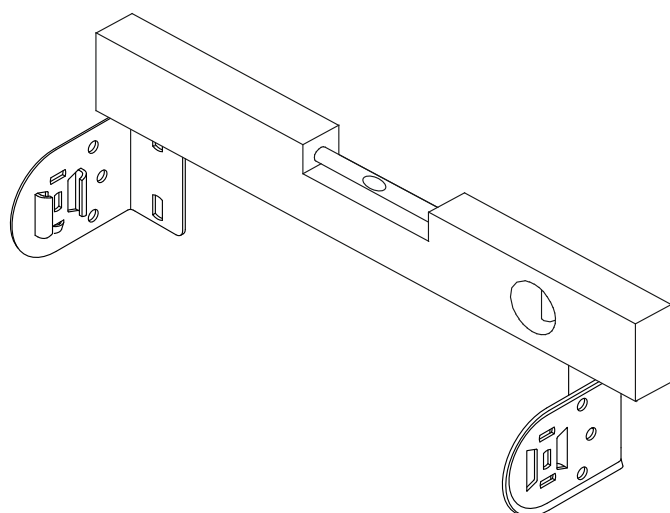

Stage II

Place the plastic covers on the installed hangers.

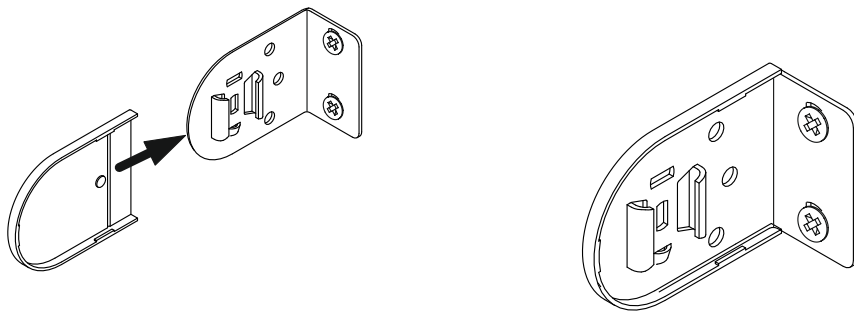

Stage III

Slide the plastic elements into the blind.

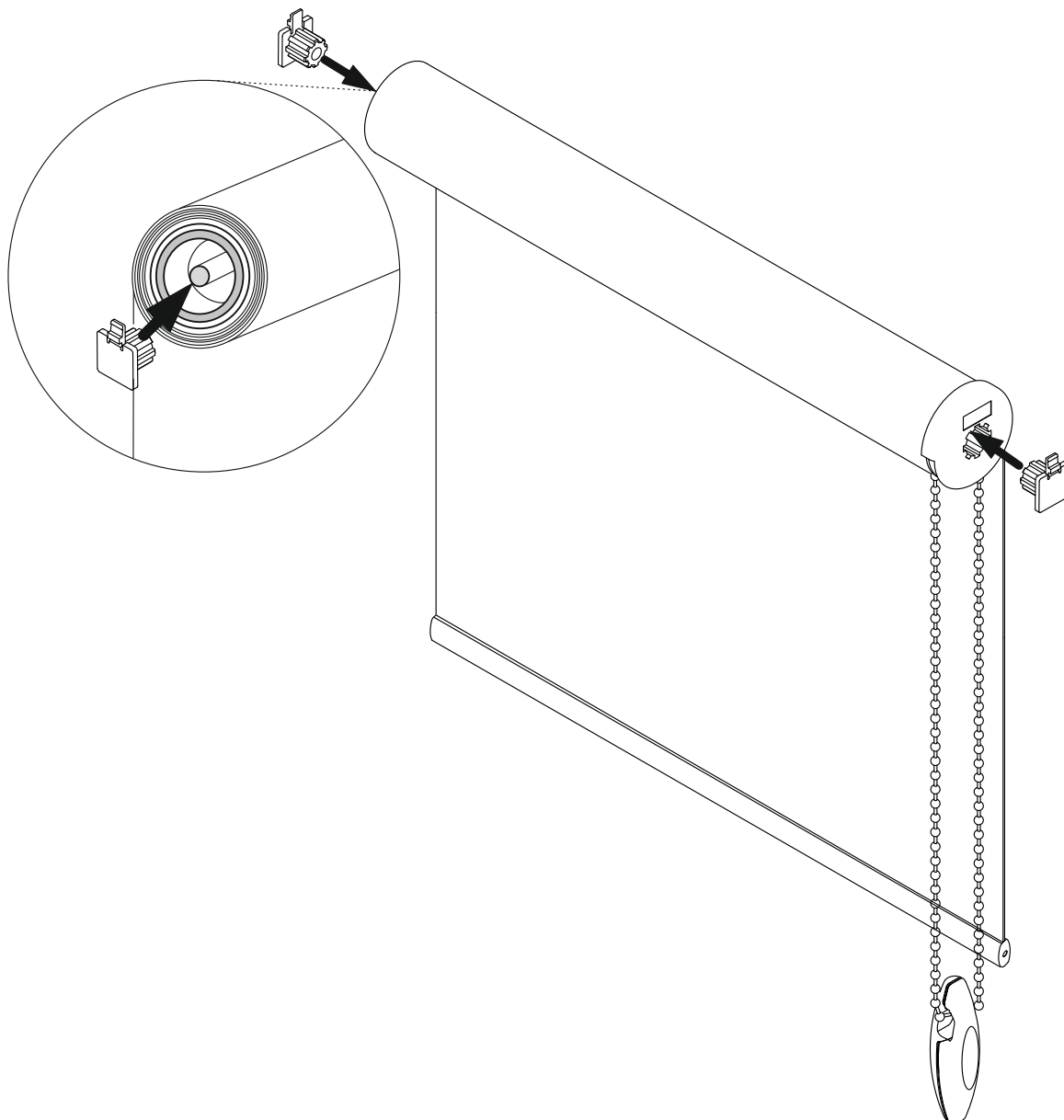

Stage IV
Place the blind on the mounting hangers.

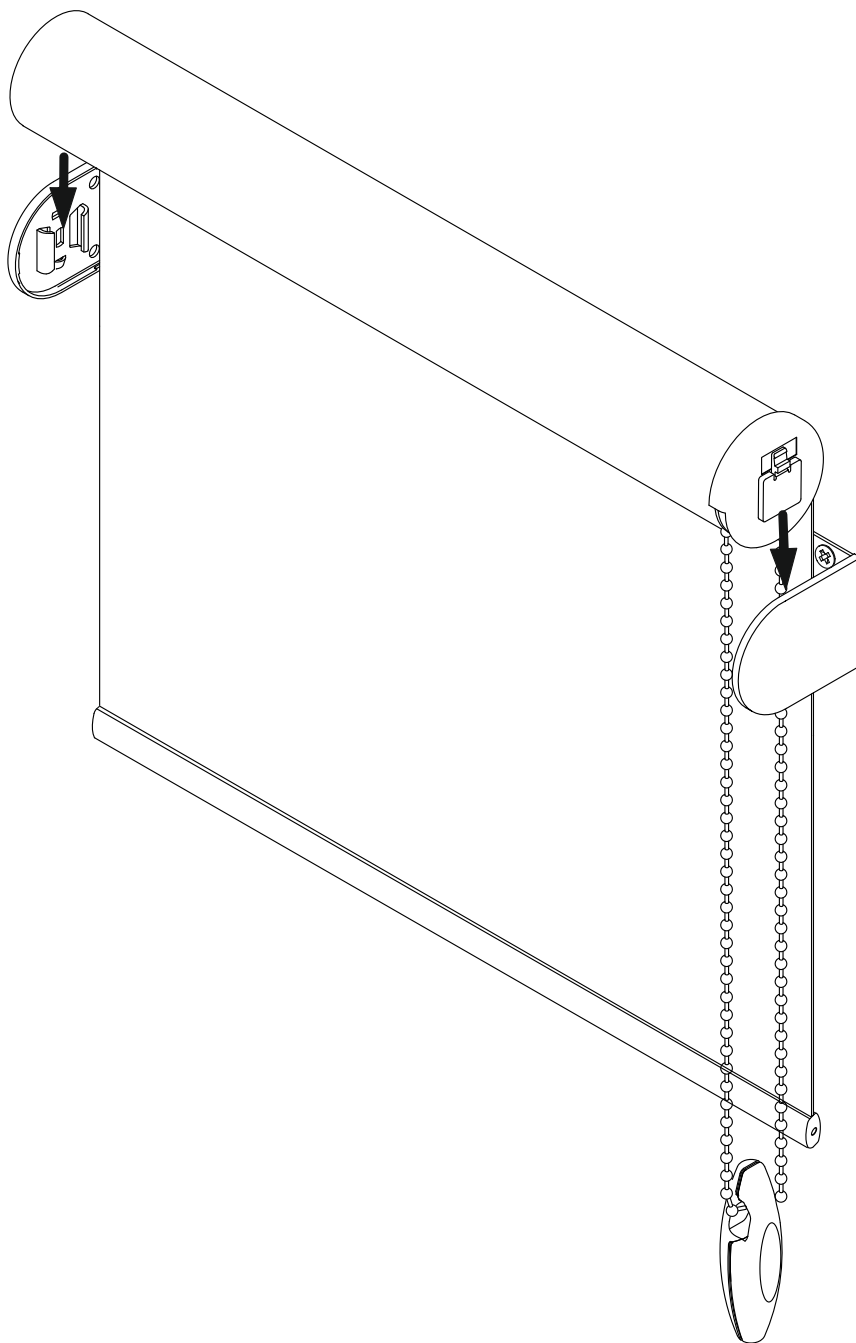

Stage V

Place the roller blind stoppers on the operating chain.

