

Installation instructions for vertical blinds

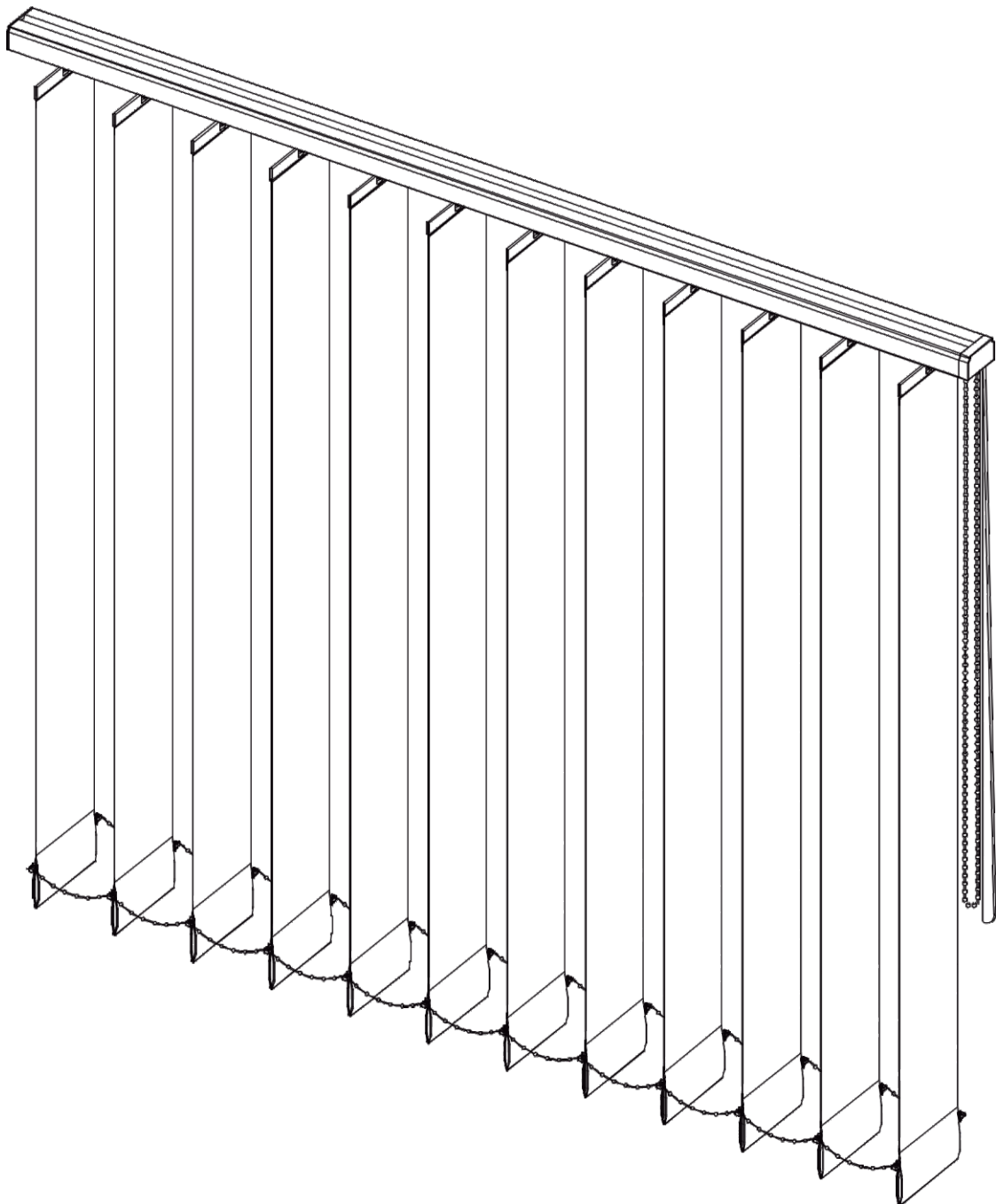

The following mounting clips are supplied with the blinds. Their number depends on the width of the blind.

Minimum 2 pieces, maximum 5.

The kit does not contain mounting studs or screws. They are selected by the customer and are dependent on the material of which the building is being cut or the window woodwork is made.

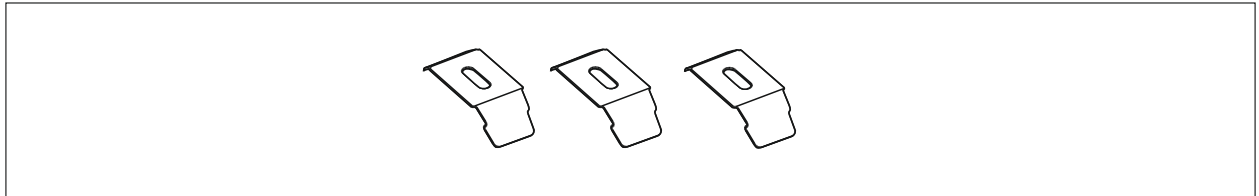

Accessories are also included in the box :

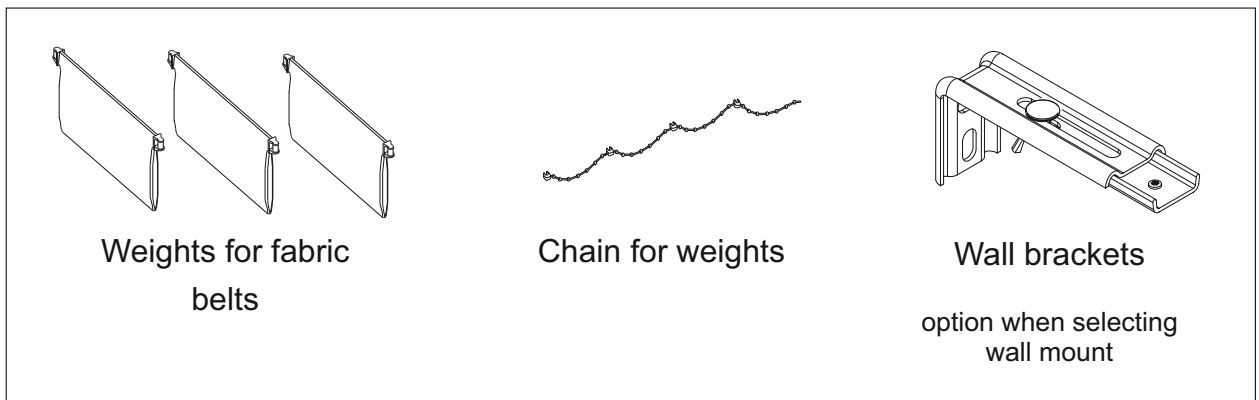

Step 1

Mount the mounting clips and click the top rail into them.

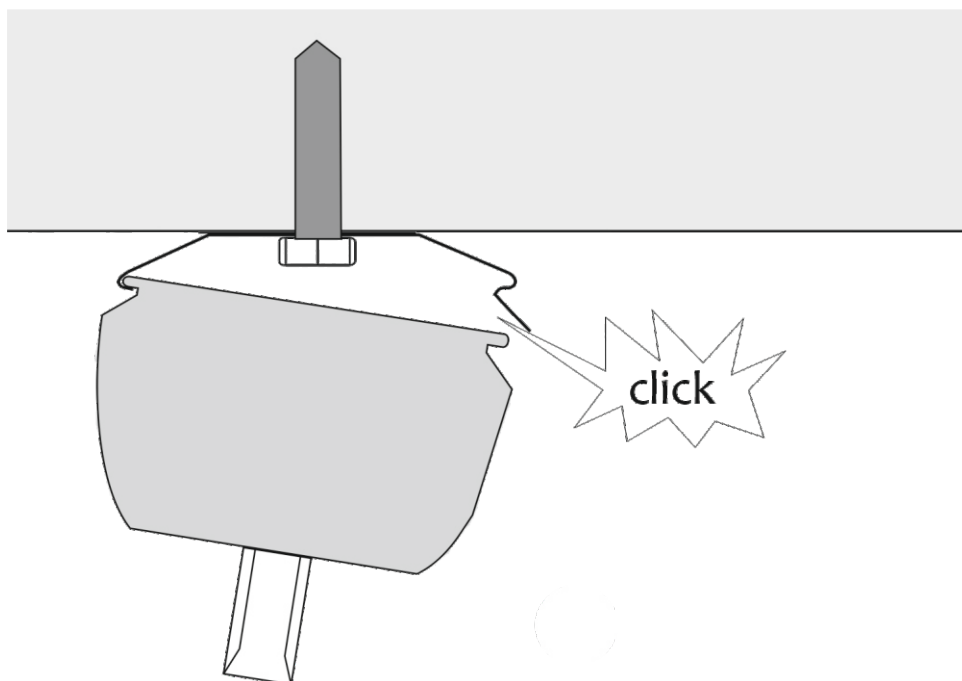

Step II
On the top rail, mount material strips.
Click them as shown on the picture below.

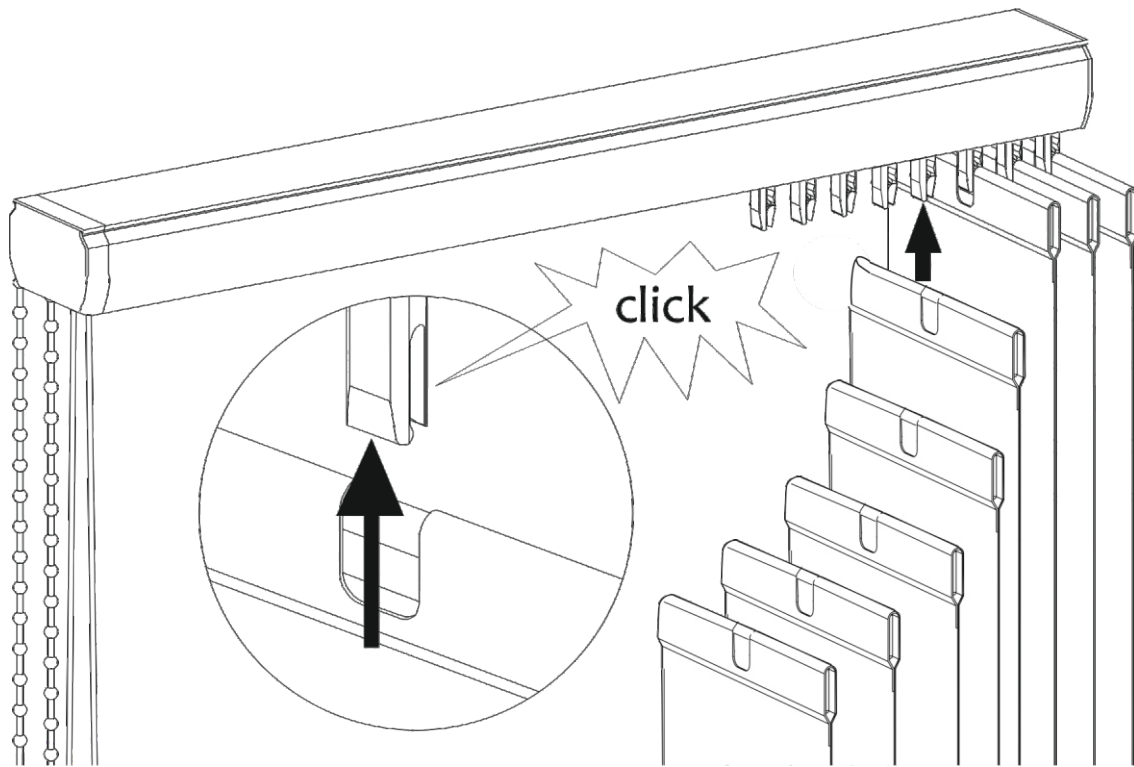

Step III
Slide the weights into the pockets at the bottom of the strips.

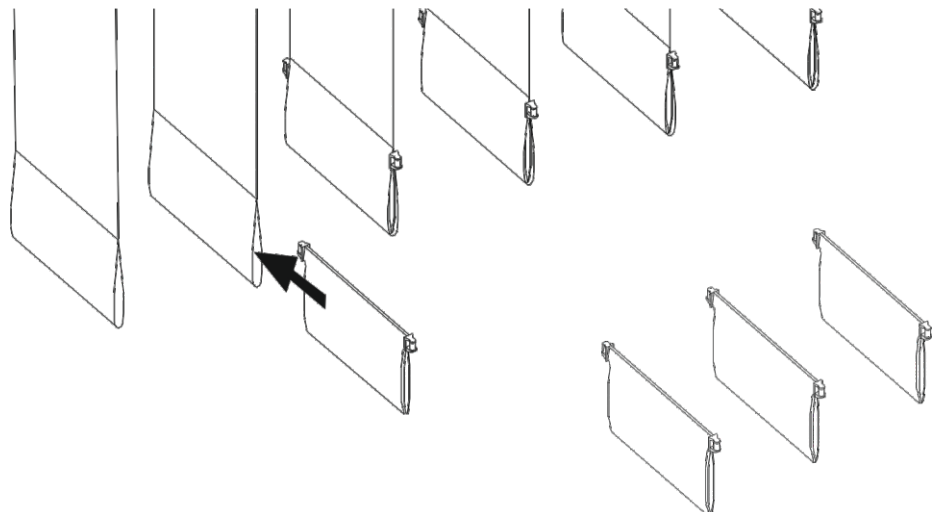

Step IV

Mount the chain on the weights and cut off the excess.

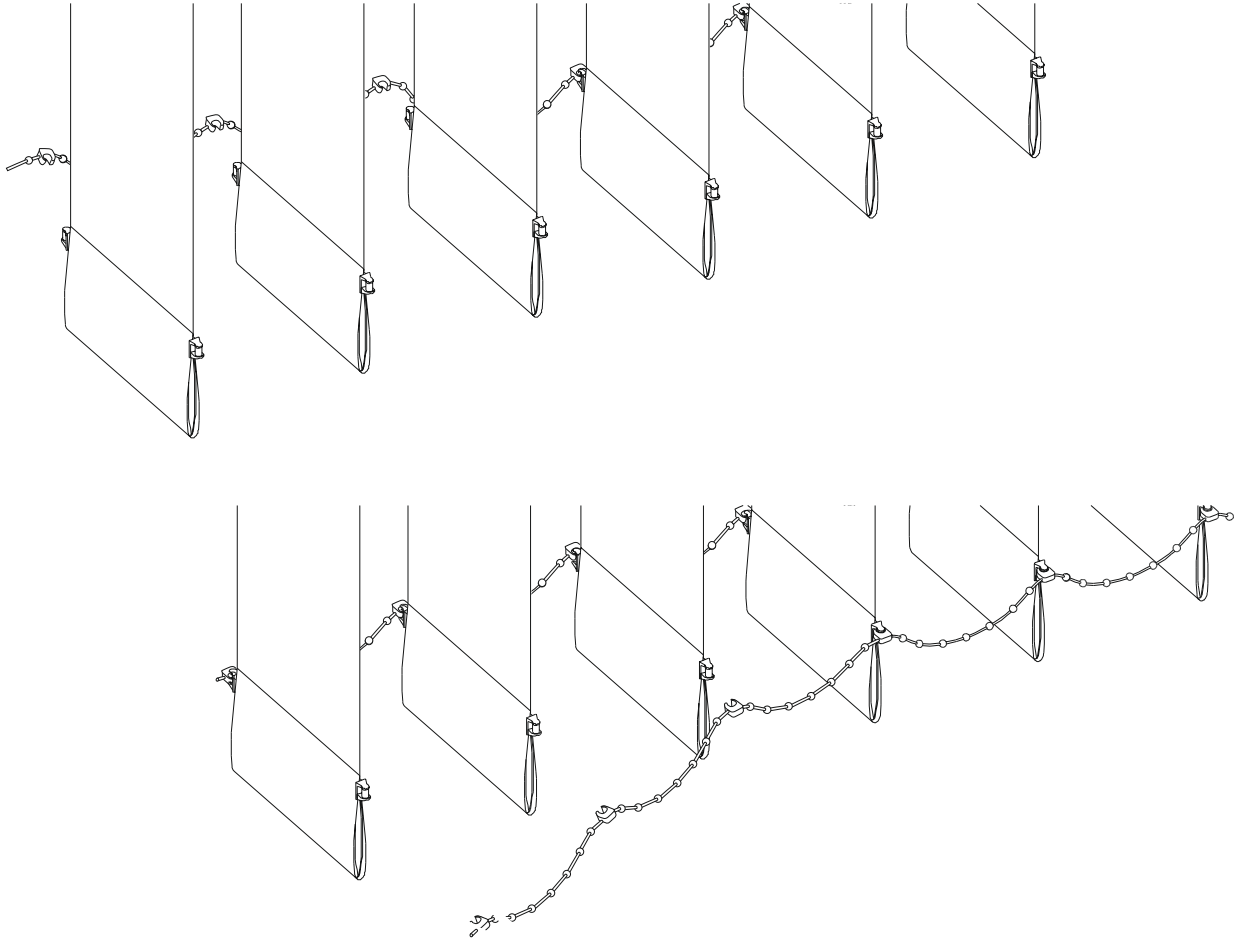

Service.

The chain is used to rotate the belts.

The twine is used to close/open the blind.

Closing and opening the blind must be performed in the open strip position.